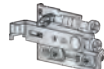
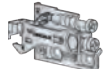

# SCARPI-4

## Cabinet hanger

Heavy duty cabinet hanger: 45Kg./unit on A setting and 35Kg./unit on B setting according to EN 15939

- > It allows three independent adjustments, easily accessible from the front side.
- > Concealed by an extra thin cover in different colours.
- > Available for knock-in or screw-on assembly.
- > The hanger is entirely made of steel and therefore it can be recycled without any problems.

|          |   |   |           |
|----------|---|---|-----------|
| <b>1</b> | SCARPI-4 .....                                    |  | ..... 216 |
|          | ■ SCARPI-4 cabinet hanger .....                   |   | ..... 216 |
|          | ■ Accessories .....                               |   | ..... 217 |
| <b>2</b> | SCARPI-4 with safety system.....                  |  | ..... 219 |
|          | ■ SCARPI-4 cabinet hanger with safety system..... |   | ..... 219 |
|          | ■ Safety system accesories .....                  |   | ..... 220 |

1 SCARPI-4

■ SCARPI-4 cabinet hanger

Euro-Screw hanger.

|             | Left        | Right       |  |
|-------------|-------------|-------------|---|
| Zinc-plated | 625.000.036 | 625.100.033 | 200   |

Euro-screw screws included.

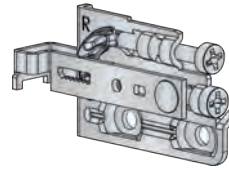
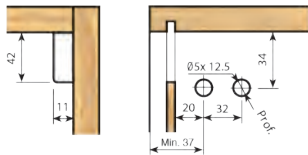

| 3 Adjustments |       |
|---------------|-------|
| Height        | 13mm. |
| Front         | 17mm. |
| Side          | 8mm.  |

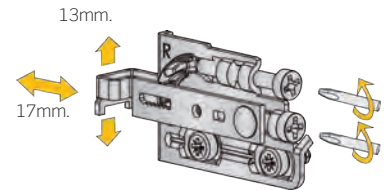

Knock-in hanger.

|             | Left        | Right       |  |
|-------------|-------------|-------------|---|
| Zinc-plated | 625.200.030 | 625.300.034 | 200   |

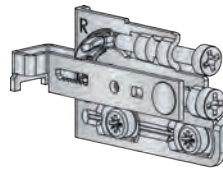
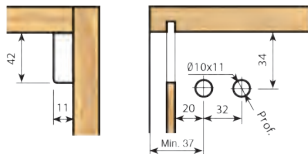

| 3 Adjustments |       |
|---------------|-------|
| Height        | 13mm. |
| Front         | 17mm. |
| Side          | 8mm.  |

Screw-on hanger.

|             | Left        | Right       |  |
|-------------|-------------|-------------|---|
| Zinc-plated | 625.400.031 | 625.500.035 | 200   |

Ø5 x 16 screws included.

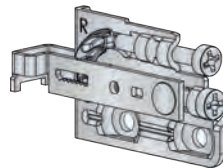
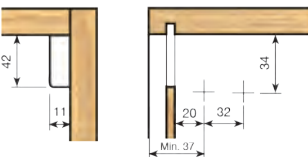

| 3 Adjustments |       |
|---------------|-------|
| Height        | 13mm. |
| Front         | 17mm. |
| Side          | 8mm.  |

Covers.

|                     | Left        | Right       |  |
|---------------------|-------------|-------------|---|
| White RAL 9001      | 639.600.006 | 639.700.003 | 400   |
| White RAL 9003      | 639.600.135 | 639.700.132 |   |
| Grey                | 639.600.146 | 639.700.143 |   |
| Anthracite RAL 7043 | 639.600.312 | 639.700.316 |   |
| Nickel*             | 639.200.063 | 639.300.060 |   |

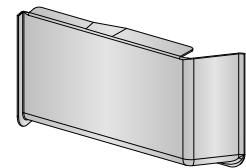
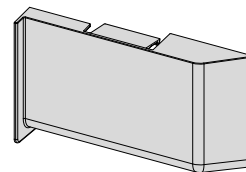

\* Nickel

■ Accessories

Bag of accessories.

|             |             |     |
|-------------|-------------|-----|
| Zinc-plated | 620.400.105 | 200 |
|-------------|-------------|-----|

Packed in boxes containing 200 bags. Each bag containing 1 double wall mounting plate. (B), 4 screws Ø4,5 x 45 (C), and 4 plastic wall plugs Ø8 x 40 (D).

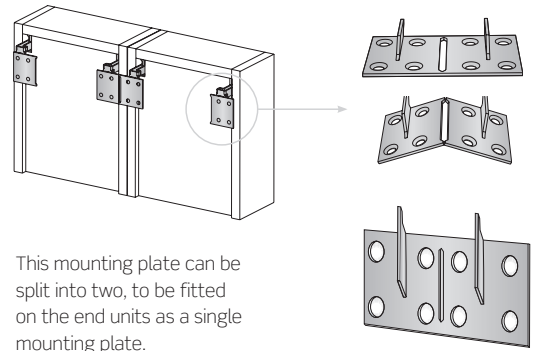

This mounting plate can be split into two, to be fitted on the end units as a single mounting plate.

Double wall mounting plate.

|             |             |     |
|-------------|-------------|-----|
| Zinc-plated | 623.000.033 | 200 |
|-------------|-------------|-----|

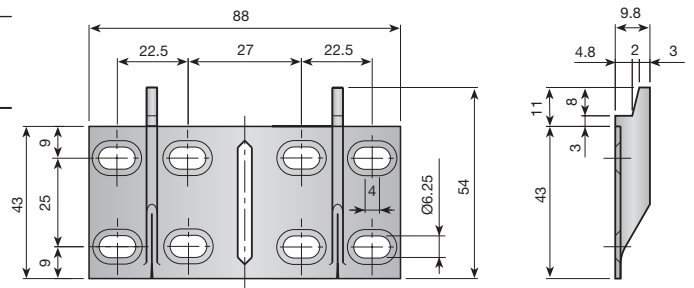

Double wall mounting plate.

| Length (mm.) | L    | Zinc-plated |     |
|--------------|------|-------------|-----|
| 200          | 158  | 623.315.033 | 150 |
| 250          | 208  | 623.320.036 | 150 |
| 300          | 258  | 623.325.032 | 150 |
| 350          | 308  | 623.330.035 | 100 |
| 400          | 358  | 623.335.031 | 100 |
| 450          | 408  | 623.340.034 | 100 |
| 500          | 458  | 623.345.030 | 52  |
| 550          | 508  | 623.350.033 | 52  |
| 600          | 558  | 623.355.036 | 52  |
| 650          | 608  | 623.360.032 | 52  |
| 700          | 658  | 623.365.035 | 52  |
| 750          | 708  | 623.370.031 | 52  |
| 800          | 758  | 623.375.034 | 52  |
| 900          | 858  | 623.385.033 | 40  |
| 1000         | 958  | 623.395.032 | 40  |
| 1200         | 1158 | 623.415.030 | 32  |
| 1350         | 1308 | 623.430.032 | 32  |

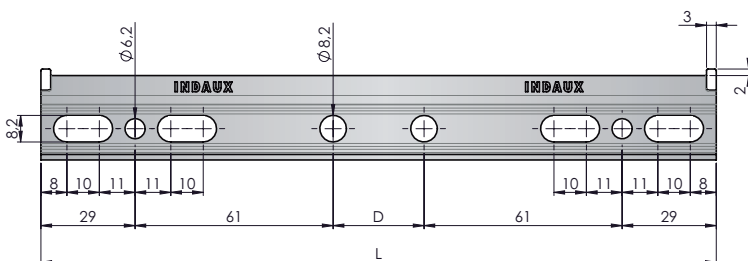
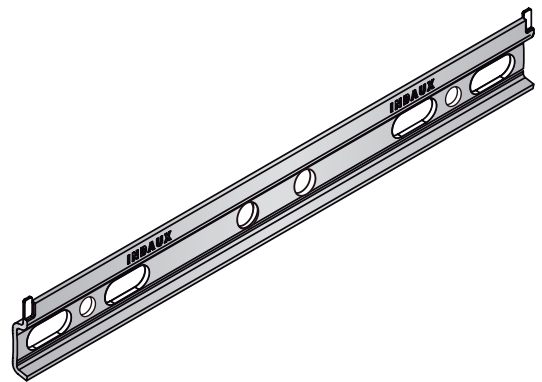

■ Accessories

Double wall mounting plate.

|              |             |     |
|--------------|-------------|-----|
| Length (mm.) |             |     |
| 130          | 621.900.031 | 200 |

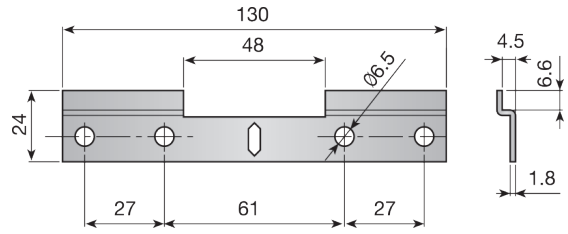

Oval holes' double plate

|              |             |    |
|--------------|-------------|----|
| Length (mm.) | Zinc-plated |    |
| 130          | 621.950.033 | 15 |

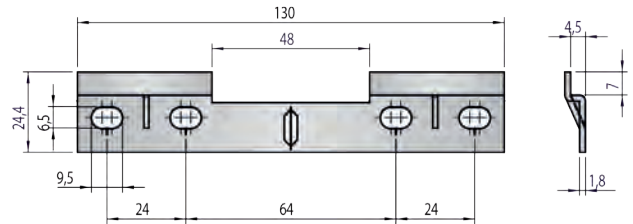

Screws Ø4,5 x 35.

|             |             |       |
|-------------|-------------|-------|
| Zinc-plated | 982.435.031 | 5.000 |
|-------------|-------------|-------|



Plastic wall plugs Ø6 x 30.

|         |             |                 |
|---------|-------------|-----------------|
| Natural | 662.130.302 | 1.000 or 10.000 |
|---------|-------------|-----------------|

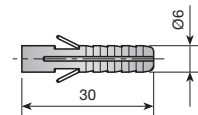

Plastic wall plugs Ø8 x 40.

|         |             |                 |
|---------|-------------|-----------------|
| Natural | 662.240.106 | 1.000 or 10.000 |
|---------|-------------|-----------------|

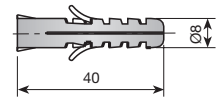

Square screw hook.

|             |             |       |
|-------------|-------------|-------|
| Zinc-plated | 661.200.035 | 1.000 |
|-------------|-------------|-------|

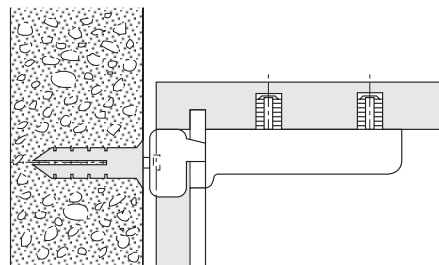
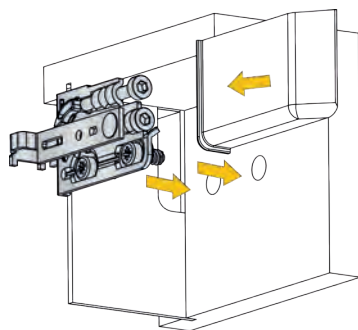
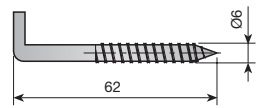

## 2 SCARPI-4 WITH SAFETY SYSTEM

### ■ SCARPI-4 cabinet hanger with safety system

#### Euro-Screw hanger with safety system for plate

|             | Left        | Right       |  |
|-------------|-------------|-------------|---|
| Zinc-plated | 629.800.032 | 629.900.036 | 200   |

Euro-screw screws included.

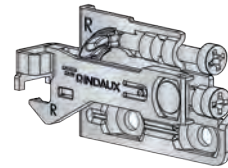
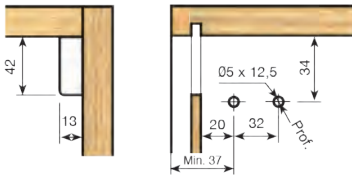

| 3 Adjustments |       |
|---------------|-------|
| Height        | 13mm. |
| Front         | 17mm. |
| Side          | 6mm.  |

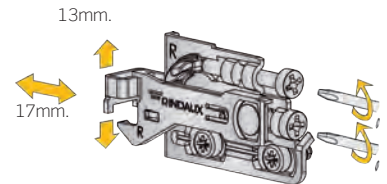

#### Knock-in hanger with safety system for plate

|             | Left        | Right       |  |
|-------------|-------------|-------------|---|
| Zinc-plated | 629.600.031 | 629.700.035 | 200   |

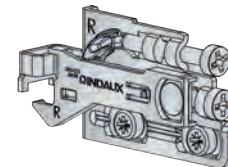
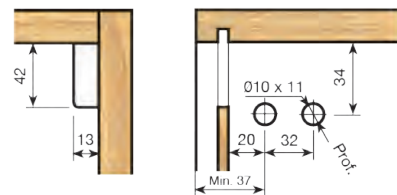

| 3 Adjustments |       |
|---------------|-------|
| Height        | 13mm. |
| Front         | 17mm. |
| Side          | 6mm.  |

#### Screw-on hanger with safety system for plate

|             | Left        | Right       |  |
|-------------|-------------|-------------|---|
| Zinc-plated | 629.400.030 | 629.500.034 | 200   |

Ø5 x 16 screws included.

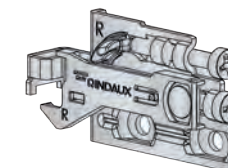
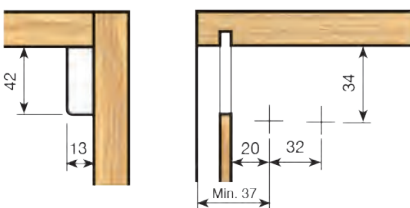

| 3 Adjustments |       |
|---------------|-------|
| Height        | 13mm. |
| Front         | 17mm. |
| Side          | 6mm.  |

#### Covers for safety system

|                     | Left        | Right       |  |
|---------------------|-------------|-------------|---|
| White RAL 9001      | 639.600.006 | 639.700.003 | 400   |
| White RAL 9003      | 639.600.135 | 639.700.132 |   |
| Grey                | 639.600.146 | 639.700.143 |   |
| Anthracite RAL 7043 | 639.600.312 | 639.700.316 |   |
| Nickel*             | 639.200.063 | 639.300.060 |   |

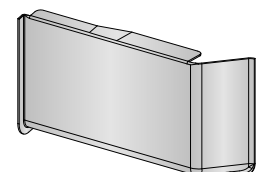
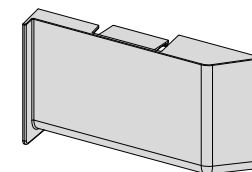

\* Nickel

#### Locking clip

|                       | Left        | Right       |  |
|-----------------------|-------------|-------------|---|
| For plate             | 629.000.492 | 629.100.496 | 200   |
| For square screw hook | 629.200.493 | 629.300.490 |   |

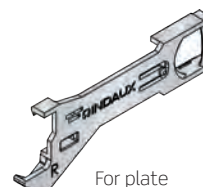

For plate

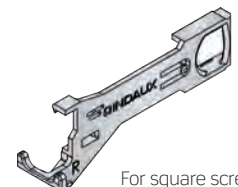

For square screw hook

**Safety system accessories**  
(can also be used with the standard system)

Bag of accessories.

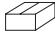
|             |             |   |     |
|-------------|-------------|---|-----|
| Zinc-plated | 628.950.103 |  | 200 |
|-------------|-------------|---|-----|

Packed in boxes containing 200 bags. Each bag containing 2 double wall mounting plates, 6 screws Ø4,5 x 45, and 6 plastic wall plugs Ø8 x 40.

Wall mounting plate.

|             |             |   |     |
|-------------|-------------|---|-----|
| Zinc-plated | 628.900.031 |  | 200 |
|-------------|-------------|---|-----|

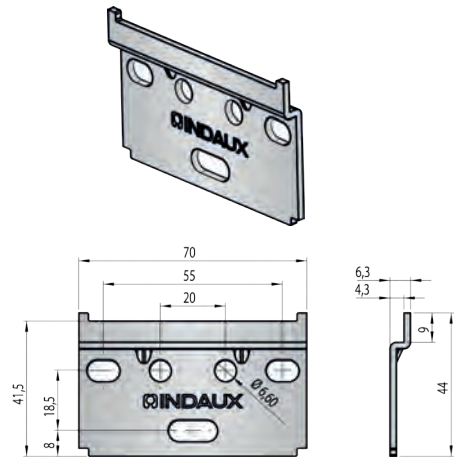
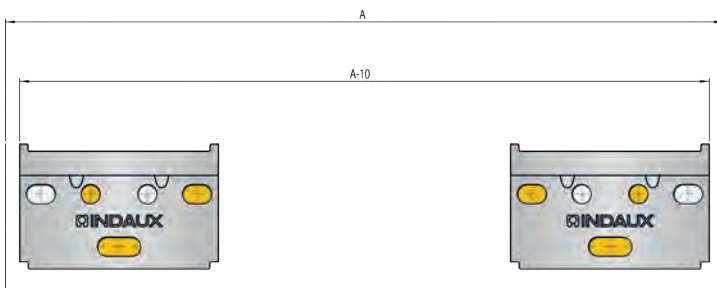

A: Distance between cabinet sides  
\* The screws must be placed in the indicated holes

Double wall mounting plate.

| Length (mm.) | L    | Zinc-plated |  |
|--------------|------|-------------|---|
| 200          | 158  | 623.315.033 | 150   |
| 250          | 208  | 623.320.036 | 150   |
| 300          | 258  | 623.325.032 | 150   |
| 350          | 308  | 623.330.035 | 100   |
| 400          | 358  | 623.335.031 | 100   |
| 450          | 408  | 623.340.034 | 100   |
| 500          | 458  | 623.345.030 | 52  |
| 550          | 508  | 623.350.033 | 52  |
| 600          | 558  | 623.355.036 | 52  |
| 650          | 608  | 623.360.032 | 52  |
| 700          | 658  | 623.365.035 | 52  |
| 750          | 708  | 623.370.031 | 52  |
| 800          | 758  | 623.375.034 | 52  |
| 900          | 858  | 623.385.033 | 40  |
| 1000         | 958  | 623.395.032 | 40  |
| 1200         | 1158 | 623.415.030 | 32  |
| 1350         | 1308 | 623.430.032 | 32  |

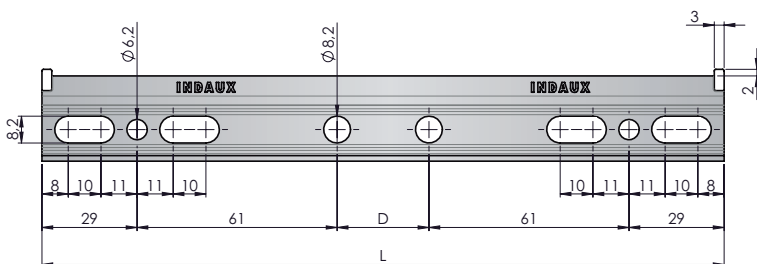

■ Accessories

Screws  $\varnothing 4,5 \times 35$ .

|             |             |   |
|-------------|-------------|---|
|             |             |  |
| Zinc-plated | 982.435.031 | 5.000   |



Plastic wall plugs  $\varnothing 6 \times 30$ .

|         |             |   |
|---------|-------------|---|
|         |             |  |
| Natural | 662.130.302 | 1.000 or 10.000   |

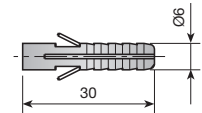

Plastic wall plugs  $\varnothing 8 \times 40$ .

|         |             |   |
|---------|-------------|---|
|         |             |  |
| Natural | 662.240.106 | 1.000 or 10.000   |

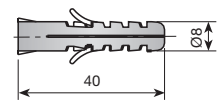

Square screw hook.

|             |             |   |
|-------------|-------------|---|
|             |             |  |
| Zinc-plated | 661.200.035 | 1.000   |

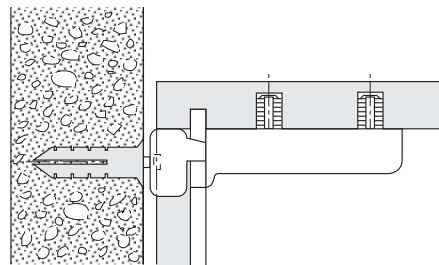
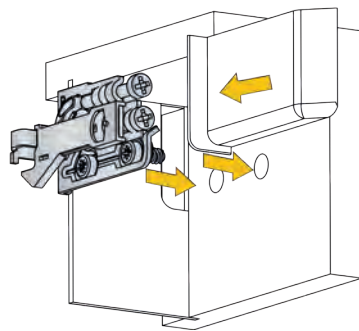
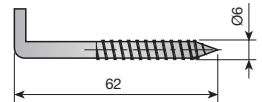

# SCARPI-5

## Cabinet hanger

Heavy duty cabinet hanger: 35Kg./unit on A setting according to EN 15939.  
Available for knock-in or screw-on assembly.

|          |                                 |            |
|----------|---------------------------------|------------|
|          |                                 | <i>pp.</i> |
| <b>1</b> | SCARPI-5 .....                  | 222        |
|          | ■ SCARPI-5 cabinet hanger ..... | 223        |
|          | ■ Accessories .....             | 224        |

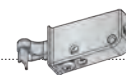



1 SCARPI-5

■ SCARPI-5 cabinet hanger

Heavy duty cabinet hanger: 35Kg./unit on A setting according to EN 15939. Concealed by a cover in different colours.

Cover for screw-fix cabinet hanger

|       |          | Left        | Right       |  |
|-------|----------|-------------|-------------|---|
| White | RAL 9001 | 626.250.004 | 626.350.001 | 250   |
| White | RAL 9003 | 626.250.133 | 626.350.130 |   |

Fixing the hanger with 2 screws Ø3,5 x 16.

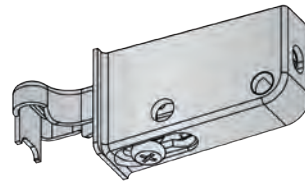
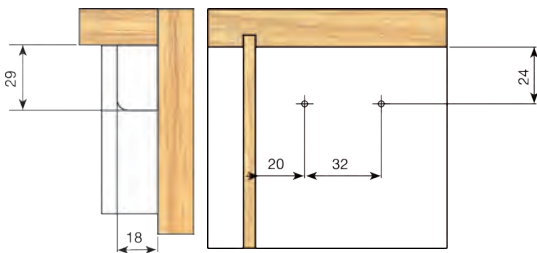

| 3 Adjustments |       |
|---------------|-------|
| Height        | 14mm. |
| Front         | 15mm. |
| Side          | 6mm.  |

Cover

|       |         | Left        | Right       |  |
|-------|---------|-------------|-------------|---|
| White | RAL9001 | 638.800.002 | 638.900.006 | 500   |
| White | RAL9003 | 638.800.131 | 638.900.135 |   |



Cover for Knock-in hanger

|       |          | Left        | Right       |  |
|-------|----------|-------------|-------------|---|
| White | RAL 9001 | 626.400.003 | 626.500.000 | 250   |
| White | RAL 9003 | 626.400.132 | 626.500.136 |   |

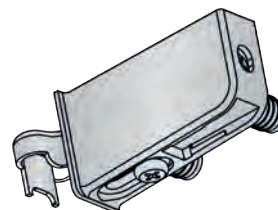
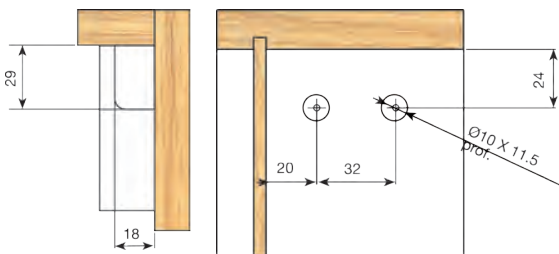

| 3 Adjustments |       |
|---------------|-------|
| Height        | 14mm. |
| Front         | 15mm. |
| Side          | 6mm.  |

Cover

|       |          | Left        | Right       |  |
|-------|----------|-------------|-------------|---|
| White | RAL 9001 | 639.400.005 | 639.500.002 | 500   |
| Grey  |          | 639.400.145 | 639.500.142 |   |

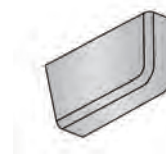

■ Accessories

Bag of accessories.

|             |   |
|-------------|---|
|             |  |
| 620.400.105 | 200   |

Packed in boxes containing 200 bags. Each bag containing 1 double wall Mounting plate. (B), 4 screws Ø4.5 x 45 (c), and 4 plastic wall plugs Ø8 x 40 (d).

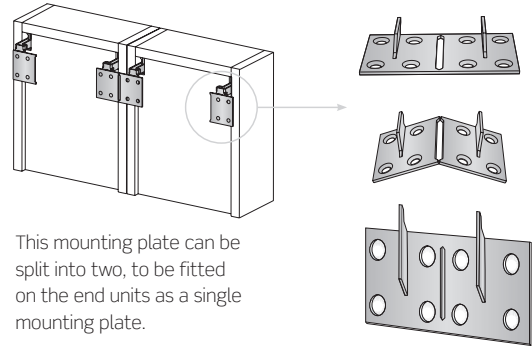

Double wall mounting plate.

|                         |   |
|-------------------------|---|
|                         |  |
| Zinc-plated 623.000.033 | 200   |

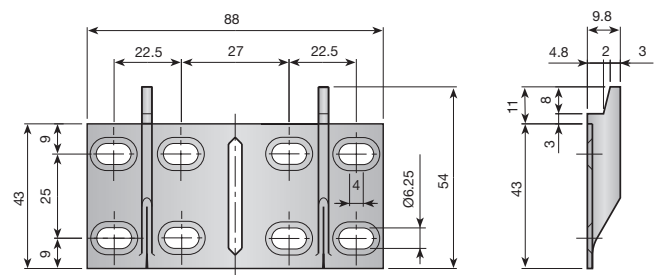

Wall mounting plate

|                         |   |
|-------------------------|---|
|                         |  |
| Zinc-plated 626.700.034 | 200   |

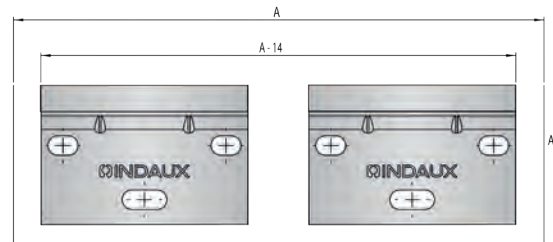
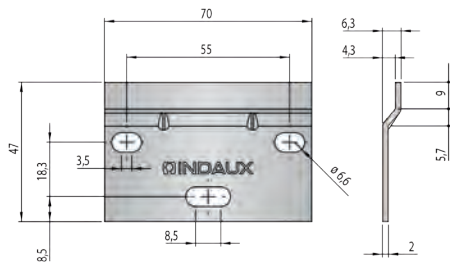

A: Distance between cabinet sides.

Double wall mounting plate

|             |             |   |
|-------------|-------------|---|
| Length (mm) | Zinc-plated |  |
| 110         | 626.850.033 | 200   |

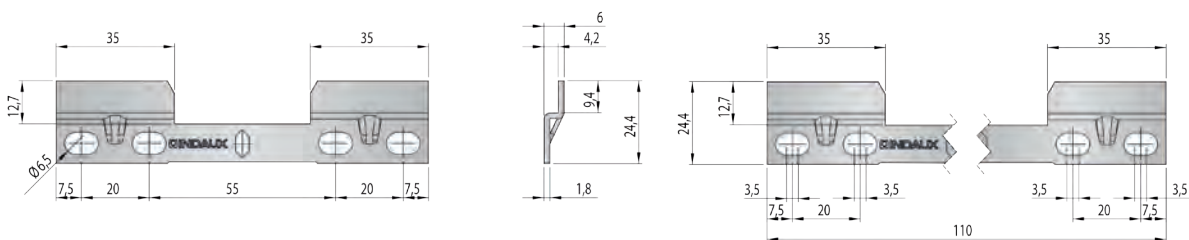
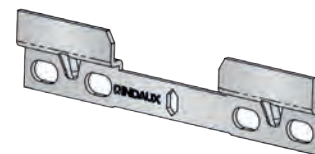

Screws Ø4,5 x 35.

|             |             |   |
|-------------|-------------|---|
|             |             |  |
| Zinc-plated | 982.435.031 | 5.000   |



Plastic wall plugs Ø6 x 30.

|         |             |   |
|---------|-------------|---|
|         |             |  |
| Natural | 662.130.302 | 1.000 or 10.000   |

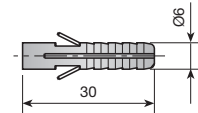

Plastic wall plugs Ø8 x 40.

|         |             |   |
|---------|-------------|---|
|         |             |  |
| Natural | 662.240.106 | 1.000 or 10.000   |

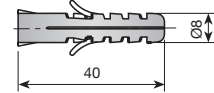

Square hook.

|             |             |   |
|-------------|-------------|---|
|             |             |  |
| Zinc-plated | 661.200.035 | 1.000   |

